

Ikegami

Medical Grade Digital Video Recorder
MDR-600HD

◆ High Quality - Full HD

◆ User Friendly - Simple Operation

◆ Standalone + Dual Recording

◆ Network Transfer*



* This may be an option in some regions.

Ikegami's medical grade digital video recorder MDR-600HD brings high quality and convenience.

High Definition Medical Image & Video Recorder. Various types of video signals (SD & HD) can be recorded by simple operation. Reliable simultaneous recording and playback feature on Internal HDD or External USB-device are also available.



System Configuration (example)

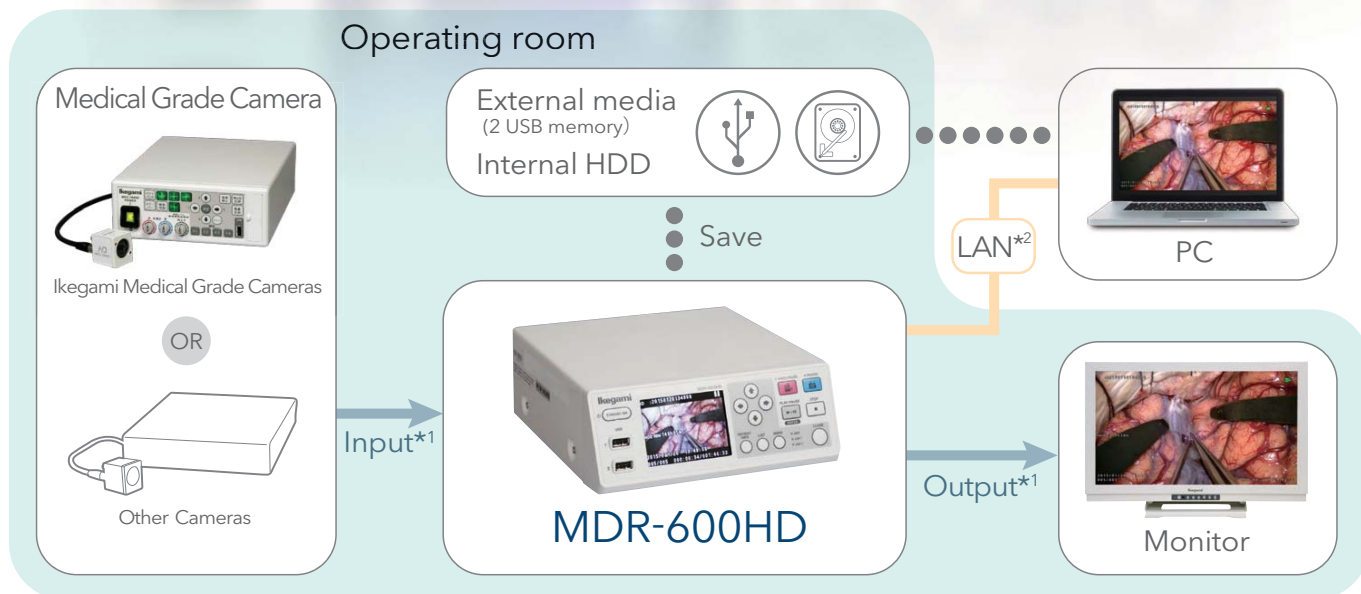

*1 Digital:SD-SDI/HD-HDI/DVI-D Analog:COMPOSITE/S-VIDEO.Input signal and output signal must be same.
 *2 This may be an option in some regions.

High Quality
Full HD

User Friendly
Simple Operation

Standalone +
Dual Recording

Network Transfer*
* This may be an option in some regions.

Key Features

High Quality Video and Still Image

High quality SD/HD video and still image (640x480 to 1920x1080) can be recorded and played back simultaneously.

Dual Recording Feature

Simultaneous recording feature on Internal HDD* and External USB device secure data reliability. Maximum 3-way recording (Internal HDD and 2x USB devices) is available.

* Internal HDD can be used to back up data.

Auto-Signal Detection & Auto-Resolution Following

Simply connect with video input device, it enables the auto-signal detection, the auto-resolution following feature and quick-start.

Image-Data Transfer Feature

Transferring data using LAN*, retrieving data from internal HDD or mass storage device using USB cable, and auto forwarding to FTP/CIFS server* are available.

* These functions may be options in some regions.

Various Search Feature

Patient data (Date, ID, Name, DOB, Sex) can be searched and reproduced quickly.

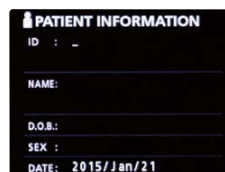

Simultaneous Recording and Playback Feature

Still image can be saved during video recording, also video or still image can be played back during video recording period.

Simple Operation

Just one button "Video" can start recording video, also just "Photo" button can start recording still image.

Built-in LCD Monitor

Recording or Playback video can be checked on a LCD monitor. Also unit status and remaining data space can be displayed.



External Contact Switch

External contact (foot) switch can control recording start, stop and hold.

Compact Design

Achieved high-performance and compact body.

Recording Time

SD(640x480)

Media	5Mbps	8 Mbps	10Mbps
HDD(500GB)*	180 hours	135 hours	100 hours
External Media(1TB)	360 hours	270 hours	200 hours

HD(1920 x1080)

Media	12Mbps	18 Mbps	24 Mbps
HDD(500GB)*	90 hours	60 hours	45 hours
External Media(1TB)	180 hours	120 hours	90 hours

* If free space is less than 100GB, data will be deleted from old ones.

Rating • Performance

Recording Media		
Internal	2.5-inch HDD (Data capacity 450GByte)	
External	USB drive (Flash Memory or HDD) *USB memory has no warranty.	
Display	3.5-inch, Full Color LCD	
Input Signal		
Video	Analog (NTSC/PAL)	
	COMPOSITE	1.0 Vp-p 75Ω
	S-VIDEO	1.0 Vp-p 75Ω luminance signal
	NTSC	0.286 Vp-p 75Ω chrominance signal
	PAL	0.3 Vp-p 75Ω chrominance signal
	Digital (High Resolution Video)	
	SD	SD-SDI NTSC(480i),PAL(576i)
	HD-SDI	1080p,1080i,720p
DVI-D	640 x 480 - 1920 x 1200 (1920 x 1200 will be reduced to 1728 x 1080)	
Audio	- 8dBs 10kΩ or more, unbalance SDI video input terminal φ3.5 stereo mini-jack x2 Audio,MIC	
Output Signal		
Video	Analog (NTSC/PAL)	
	COMPOSITE	1.0 Vp-p 75Ω
	S-VIDEO	1.0 Vp-p 75Ω luminance signal
	NTSC	0.286 Vp-p 75Ω chrominance signal
	PAL	0.3 Vp-p 75Ω chrominance signal
	Digital (High Resolution Video)	
	SDI	SD-SDI NTSC(480i),PAL(576i)
	HD-SDI	1080p,1080i,720p
DVI-D	640 x 480 - 1920 x 1200	
Audio	-8dBs 1kΩ unbalance SDI video input terminal φ3.5 stereo mini-jack x1 Audio	

Interface	
LAN	RJ45 (100Base-TX/1000Base-T)(This function may be an option in some regions.)
USB-A	Recording x 2 (Front USB2.0)
USB-B	For PC connection x 1 (Rear USB2.0)
REMOTE	2.5-inch mini-jack
Contact Switch	3.5-inch mini-jack, Video x 1, Photo x 1
External Recording Media	
USB Drive	Flash Memory or HDD
Format	FAT32
Video Data Process	
Still Image	JPEG
Video Compression	MPEG-4 AVC/H.264
File Format	mov
Recording Time	90 hours. (Internal HDD 500GB, EQ: Economy Quality)
Audio Data Process	
Compression	LPCM
Sampling Freq	48KHz
Quantifying Bit Number	16bit

Safety Regulation/EMC

Safety Regulation	IEC60601-1,CSA60601-1,EN60601-1,CE
EMC	IEC60601-1-2,CSA60601-1-2,EN60601-1-2,FCC class B
Certified	CSA NRTL/C,FDA

General

Power	AC 100V - 240V ±10% 50/60 Hz 0.62A - 0.35A	
Operating Environment	Temperature	5 - 40°C
	Humidity	5 - 80% RH (non-condensing)
Dimension	W210.5 x H88.5 x D235mm (incl.rubber foot)	
Weight	2.6 kg	
Standard Accessory	Power cord x 1, Instruction Manual	

Rear Panel



Optional Unit



Dimensions(Unit:mm)

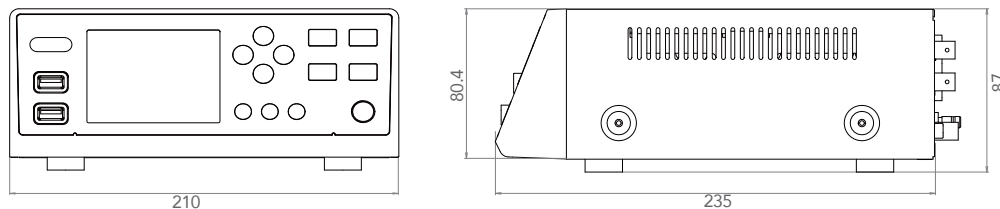

Product names and company names mentioned in this catalogue are trademarks and/or registered trademarks of their respective companies. Design and specifications are subject to change without notice.



U310A151-IB5

Ikegami Tsushinki Co.,Ltd.

■ URL : <http://www.ikegami.co.jp/en/>

- Head Office : 5-6-16 Ikegami, Ohta-ku, Tokyo 146-8567, Japan TEL.03-5700-1111 / FAX.03-5700-1137
- Overseas Sales Division : 5-6-16 Ikegami, Ohta-ku, Tokyo 146-8567, Japan TEL.03-5700-4117 / FAX.03-5748-2200
- Beijing Office : Room No.307 Tower B, Jia Tai International Mansion No.41East Fourth Ring Road, Chaoyang District, Beijing China ... TEL.010-85710350 / FAX.010-85711804

Ikegami Electronics (U.S.A.), INC.

■ URL : <http://www.ikegami.com>

- Headquarters : 37 BROOK AVENUE, MAYWOOD, NJ 07067 TEL.(201) 368-9171 / FAX.(201) 569-1626

Ikegami Electronics (Europe) GmbH

■ URL : <http://de.ikegami.co.jp>

- Headquarters : Ikegami Strasse 1, D-41460 Neuss, Germany TEL.02131-1230 / FAX.02131-102820
- U.K. Branch : 1 Windmill Business Village, Brooklands Close, Sunbury on Thames, TW16 7DY, England TEL.01932-769700 / FAX.01932-769710

Ikegami Electronics Asia Pacific Pte.Ltd. ■ URL : <http://sg.ikegami.co.jp>

- Headquarters : 1 Tampines Central 5, #3-3 CPF Tampines Building, Singapore 529508 TEL.6260-8820 / FAX.6260-8896

